

# S Series(60)

Part No.	Nominal dc spark-over voltage	Gas Discharge Tube dc spark-over voltage	Impulse spark-over voltage at 1kV/ $\mu$ s		Nominal impulse discharge current 8/20 $\mu$ s		Nominal Alternating discharge current at 50Hz, 1s	DC Holdover Voltage	Insulation resistance		Capacitance at 1kHz
	$V_{sdC}$ (V)	$V_{sdC}$ (V)	$V_{si}$ (V)		$i_{di}$ (KA)		$i_{da}$ (A)	$V_H$ (V)	V (V)	$R_{is}$ ( )	C (pF)
	(100V/s)	(100V/s)	100V/ $\mu$ s	(1kV/ $\mu$ s)	1 Time	10 Times	50Hz, 1s	<150ms			1kHz
60S75	75	60~90	$\leq 600$	$\leq 700$	8	5	5	52	50	$\geq 10^{10}$	$\leq 1$
60S90	90	72~108	$\leq 600$	$\leq 700$				52	50		
60S145	145	116~174	$\leq 600$	$\leq 700$				52	50		
60S230	230	184~276	$\leq 700$	$\leq 800$				135	100		
60S250	250	200~300	$\leq 700$	$\leq 800$				135	100		
60S300	300	240~360	$\leq 800$	$\leq 900$	5	3	135	100			
60S350	350	290~420	$\leq 800$	$\leq 900$			135	100			
60S400	400	320~480	$\leq 900$	$\leq 1000$			135	100			
60S470	470	376~564	$\leq 1000$	$\leq 1100$			135	100			
60S600	600	480~720	1300	1500			150	100			

## S Type

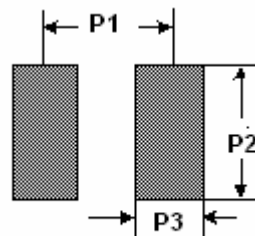
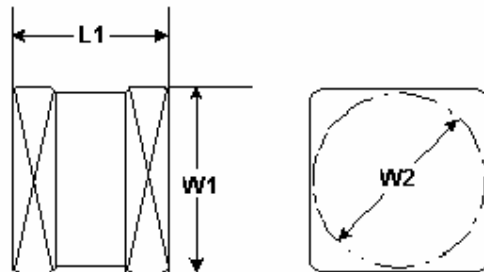

Recommended Pad Size

# S Series(40)

Part No.	Nominal dc spark-over voltage	Gas Discharge Tube dc spark-over voltage	Impulse spark-over voltage at 1kV/ $\mu$ s		Nominal impulse discharge current 8/20 $\mu$ s		Nominal Alternating discharge current at 50Hz, 1s		DC Holdover Voltage	Insulation resistance		Capacitance at 1kHz
	$V_{sdc}$ (V)	$V_{sdc}$ (V)	$V_{si}$ (V)		$i_{di}$ (KA)		$i_{da}$ (A)		$V_H$ (V)	V (V)	$R_{is}$ ( )	C (pF)
	(100V/s)	(100V/s)	100V/ $\mu$ s	(1kV/ $\mu$ s)	1 Time	10 Times	50Hz, 1s	Single 9 cycles	<150ms			1kHz
40S75	75	60~90	$\leq 700$	$\leq 800$	5	3	3	6	52	50	$\geq 10^{10}$	$\leq 1$
40S90	90	72~108	$\leq 600$	$\leq 700$					52	50		
40S145	145	116~174	$\leq 600$	$\leq 700$					52	50		
40S230	230	184~276	$\leq 700$	$\leq 800$					135	100		
40S250	250	200~300	$\leq 700$	$\leq 800$					135	100		
40S300	300	240~360	$\leq 800$	$\leq 900$	5	3	3	6	135	100		
40S350	350	290~420	$\leq 800$	$\leq 900$					135	100		
40S400	400	320~480	$\leq 900$	$\leq 1000$					135	100		
40S470	470	376~564	$\leq 1000$	$\leq 1100$					135	100		
40S600	600	480~720	$\leq 1300$	$\leq 1500$					150	100		

## S Type

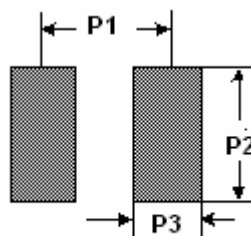
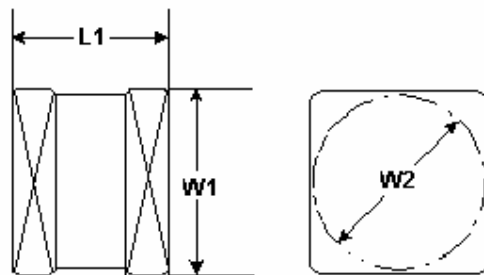

Recommended Pad Size

# S SERIES

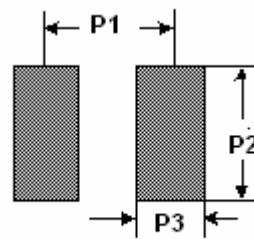
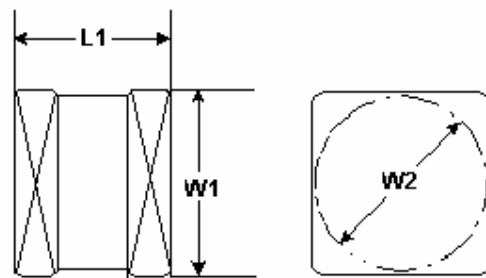

**Recommended Pad Size**

SType

Type	W1	W2	L1	P1	P2	P3
40S	4.2±0.2	6.0±0.4	4.2±0.4	3.0	5.0	0.65
60S	6.2±0.4	6.0±0.4	4.2±0.4	3.5	5.0	1.3